

| | | | |
|--------------|---------------------|--|---|
| Ground Level | The Resource centre | <p>To house facilities whereby information relating to disabilities could be obtained by both the able and differently able.</p> <p>The computer room can be used as a training room as well to teach those that would like to improve their skills or become computer literate.</p> <p>A library to acquire reading material for leisure reading or for research by both able and disabled societies.</p> <p>Exhibition space and the Library can be used to display information with respect to awareness campaigns, events, etc.</p> <p>The Exhibition space can also be used to display art from both the able and disabled communities. This would give the disabled individuals a platform to display their skills and expose their talent to their community.</p> | <p>Library with courtyard: 315m²</p> <p>Exhibition space: 115 m² to 400 m²</p> <p>Reading room – 45 m²</p> <p>Computer room – 45 m²</p> <p>Ablutions</p> |
| | Visitors' Centre | <p>A reception area for the welcoming of guests where information about the establishment and its programs can be obtained.</p> <p>A Café for easy access to refreshments by the user</p> <p>Gift shop to showcase/expose the talent of those that are mentally disabled and sell their work which would in turn give them a sense of self worth.</p> | <p>Café – 220 m²</p> <p>Gift Shop & Information Desk–150m²</p> <p>Ablutions</p> |
| | Surface Parking | Accessibility | <p>Staff Parking</p> <p>Public parking</p> <p>15 parking bays of which 3 are parking bays for disabled individuals</p> |
| | Drop off Zone | To drop off and to pick up passengers | Caters for 4 minibuses simultaneously |

DESIGN PROCESS

DESIGN PROCESS

Design Objectives

The Design evolved along with the research into understanding the community of people with mental disabilities and other disabilities. At this point it is important to summarise what has been established in the earlier chapters. By doing so we can build the overall concept.

1. Architectural design objective

- a) **Movement** - freedom of independent movement is essential to the design as the underlining objective of the project is to promote integration. Safety and comfort need to be achieved on as many levels as possible in order to create a well balanced caring environment.
- b) **Orientation** - Being able to orientate oneself is a crucial factor in the design. Various landmarks, symbols and signage would help the user identify their position in space.

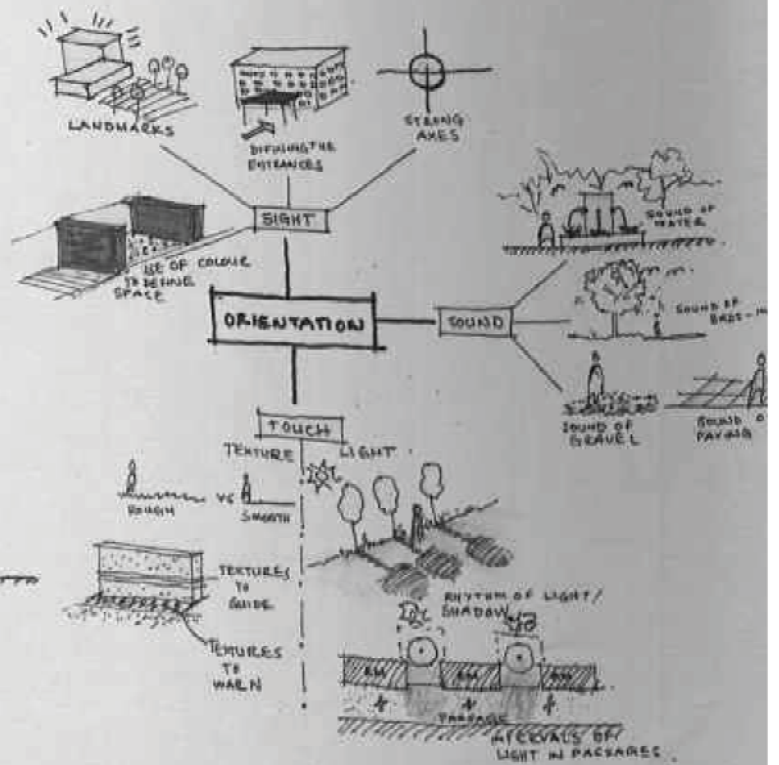
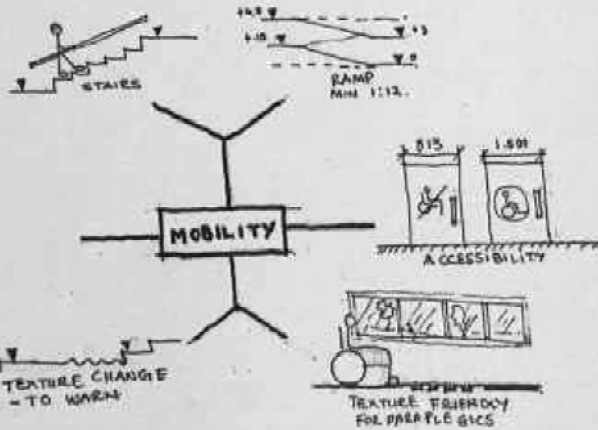

DESIGN PROCESS

Understanding the site

The first step taken was to understand the complexity of the site. This included:

1. Understanding the slopes
2. Mapping unique features on the site
3. Recording important views from the site
4. Recording important views of the site from outside its boundaries.

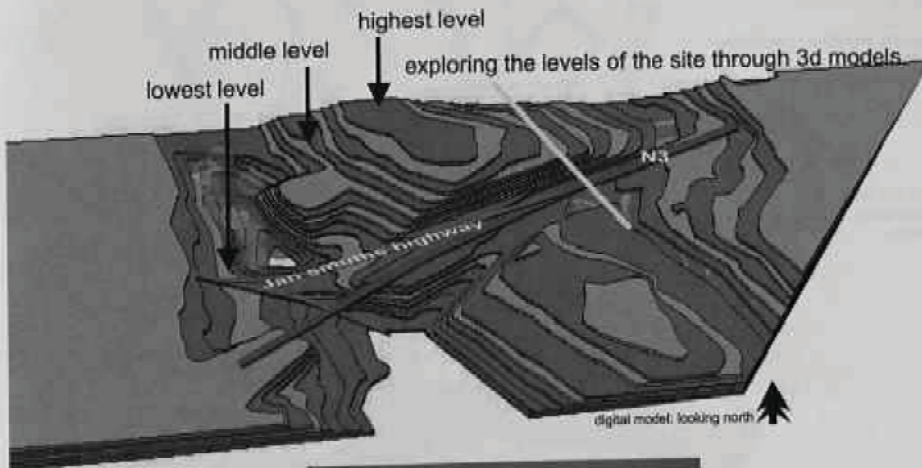

Textures and objects on site



view looking south towards the ridge

DESIGN PROCESS

Zoning: Public and Semi Public zones

After looking at the site in respect to the above mentioned items, the site was split into semi public and public zones.

Public Zone:

- Located at the lowest point of the site.
- Close to Jan Smuts Highway (a major road linking Westville and other surrounding suburbs to the city).
- Close to the existing bird nature reserve which could be an appealing characteristic for public program.

Semi Public Zone:

- Located at the highest point of the site.
- Close to Hugo Road entrance
- Has strong visual connections to the ridge as well as the N3 highway
- The typography and views from this portion of the site offers the opportunity to design a building that could be an icon for mental health.

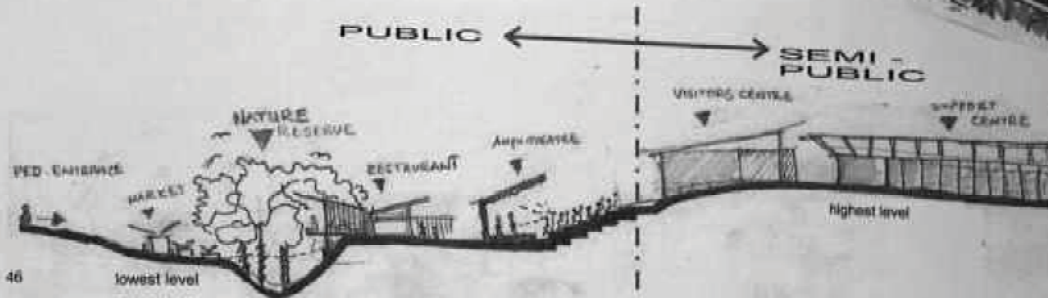
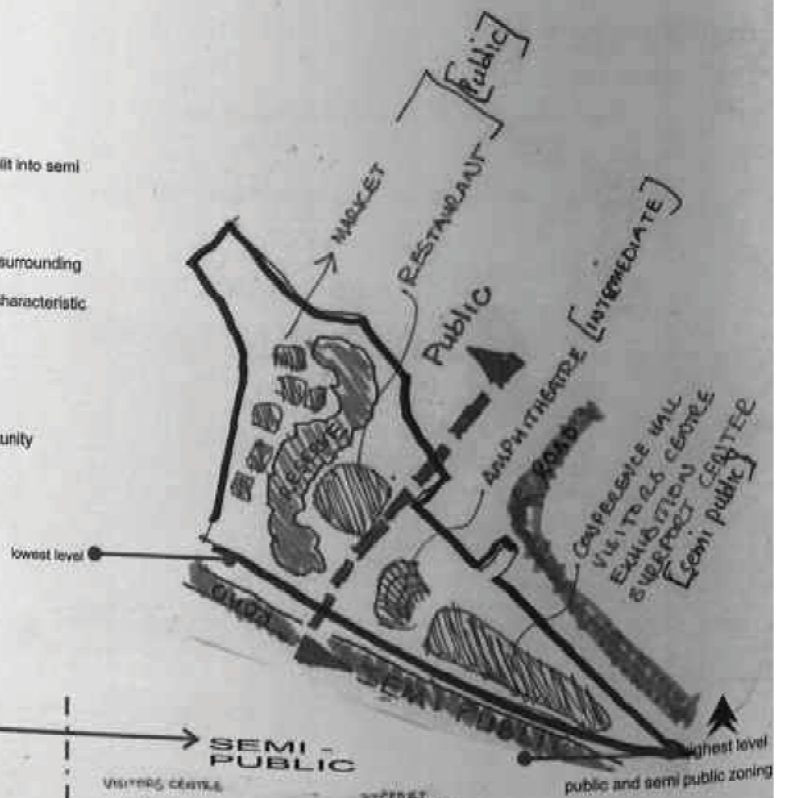

DESIGN PROCESS

Mapping the movement on and along the site

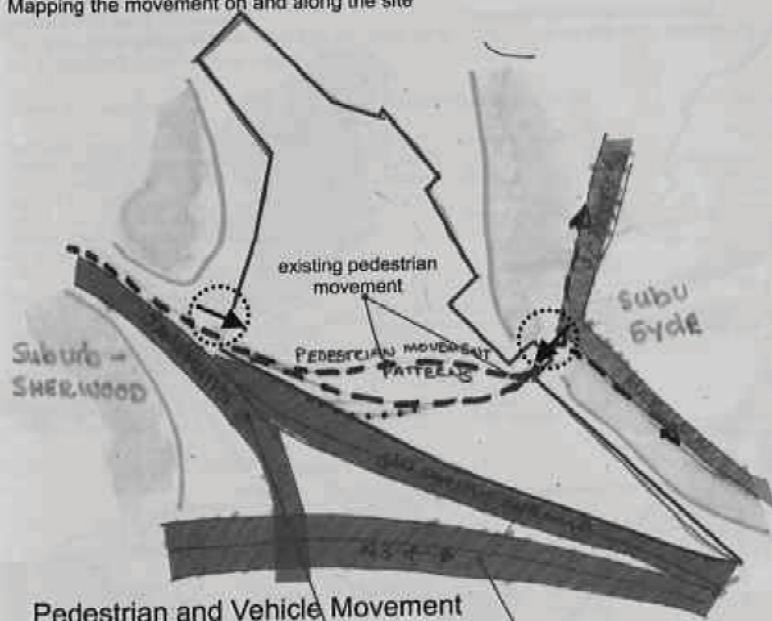

Pedestrian and Vehicle Movement

Jan Smuts Highway is a Taxi and bus route. This road links the northern suburbs such as Westville to the city.

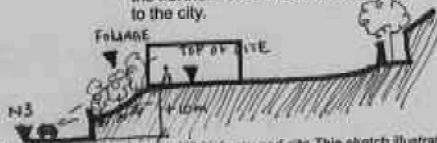

early sketch section through N3 highway and site. This sketch illustrates the difference in height between the highway and the highest point of the site.

The N3 highway passes the south side of the site. Cars, busses and taxi's travel on the N3. It links the city to other hot spots such as Pavilion shopping mall.



the sketches along side were done as part of the exercise that focused on movement of both pedestrians and vehicles. The red hatched areas are an indication of the most favorable area that relate to this exercise.



DESIGN PROCESS

EARLY DESIGN IDEAS

The sketches below are a reflection of ideas of building form at the very beginning of the project research stage. It is important to note that at this stage the program began to take shape.

The Multi-Purpose Building

Due to the passing views from the N3 highway as well as the size and location of this part of the site the only part of intervention that seemed to be appropriate is the multi purpose centre.

With single storey residential dwelling in close proximity the building should not be an overpowering building in its scale therefore the sketches illustrate a building that tucks into the slopes of the landscape with turf roofs that can be used.

Information Centre

the sketch illustrates the idea of a building tucked away in to the landscape.

The spaces stretch out into the existing canopies.

The logic of the arrange of spaces is simple. The exhibition space is shown to be the first space encountered by the user, followed by an internet and the library reception desk which leads to the library and outside deck. Each space is visually separated by glimpses of the outside.

Market Space

The market space is envisaged as a space that is governed by one main route, this route is defined by pavilions lining the reserve (south) edge and the existing trees on the north creating an organic space.

The route culminates with an organic market and herb nursery.

Restaurant / Café

The restaurant is situated on the middle level and near the existing foot path of the site, close to the dense tree foliage. The building sits on the landscape however its engulfed by the canopies of the trees.

The seating areas are stretched over a covered space and an open aired space with the services on the south.

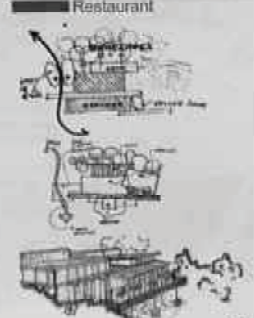
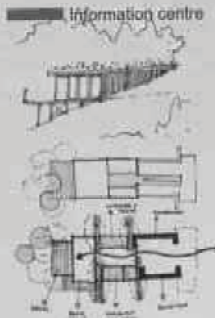
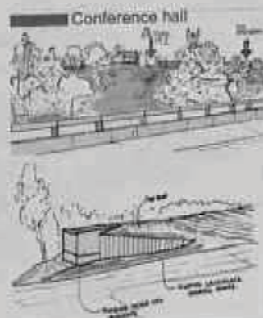

DESIGN PROCESS

Connectivity -applying the idea of focal points

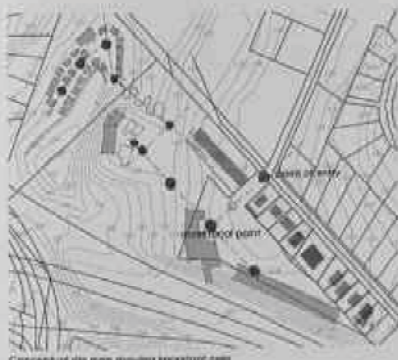

Conceptual site map showing movement and

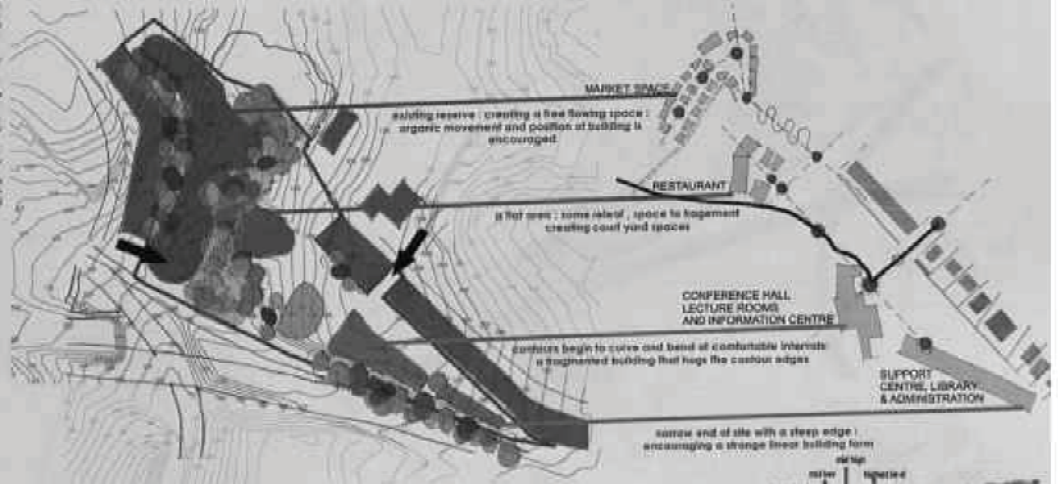

- INFORMATION CENTRE
- CONFERENCE CENTRE
- AMPHITHEATRE
- RESTAURANT
- OPENING AND CIVIL MARKET
- EXISTING RESIDENTIAL DEVELOPMENT



DESIGN PROCESS

Design development

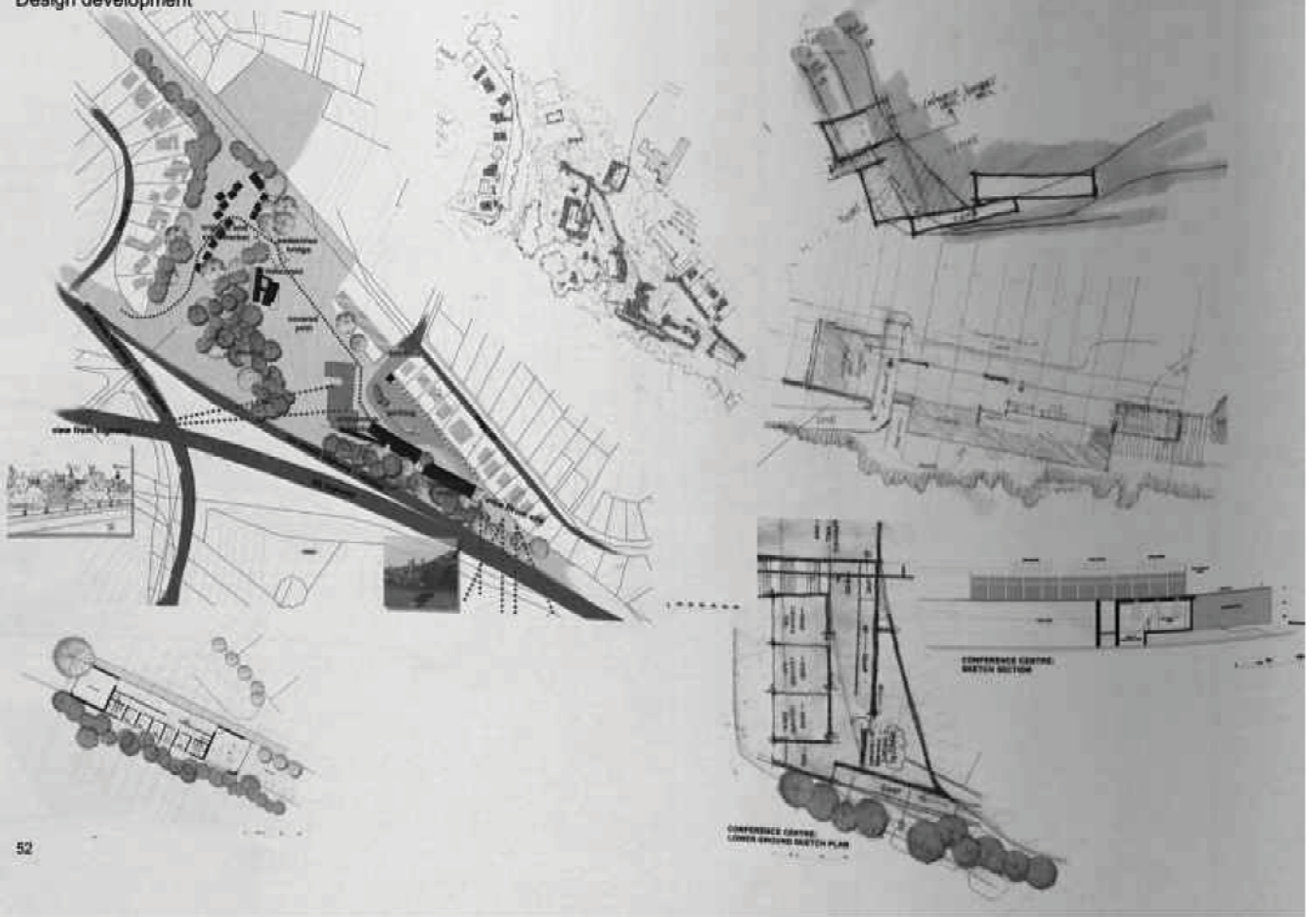

DESIGN PROCESS

Design development

DESIGN PROCESS
Design development

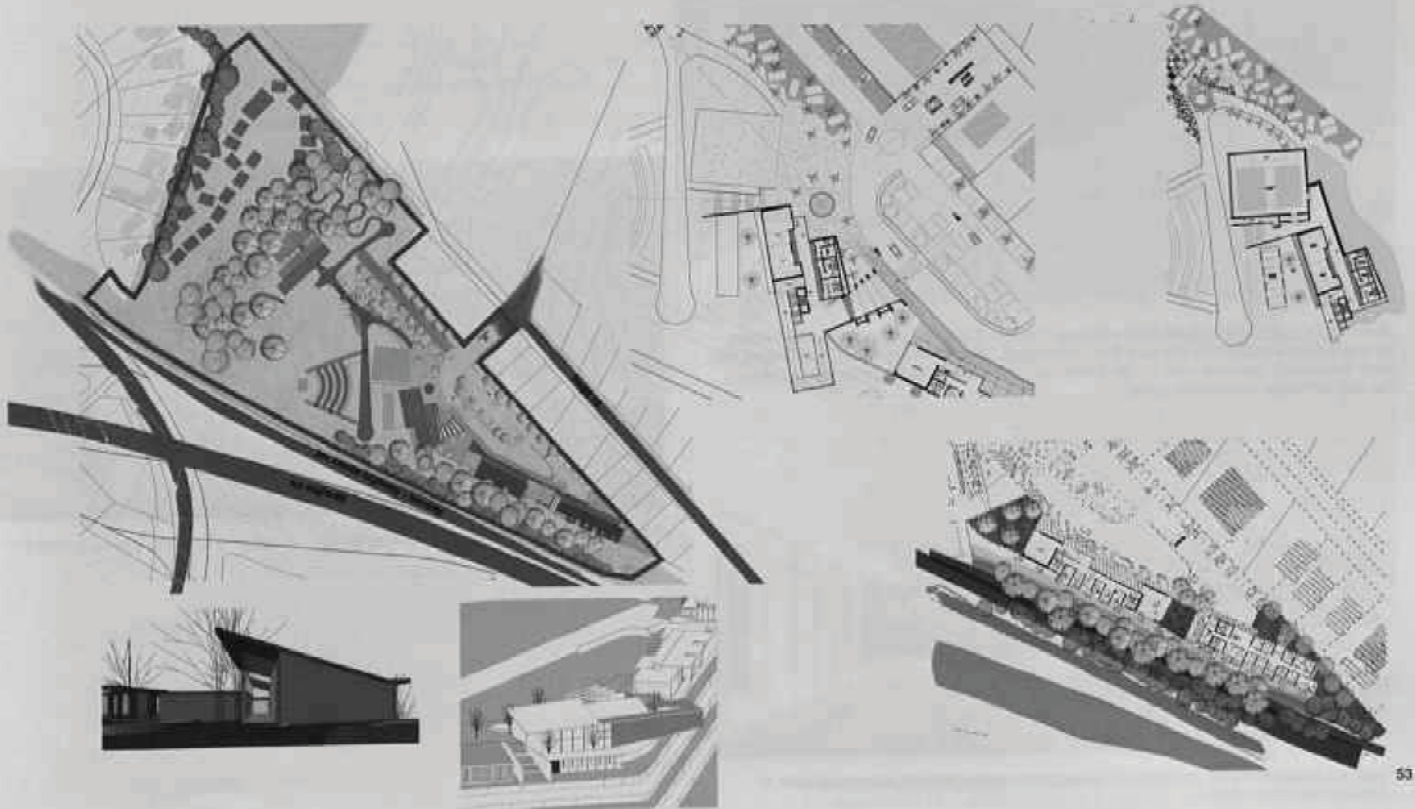

DESIGN PROCESS

Design development



Sketch perspective showing internal entrance space of building. The use of bright colours on wall surfaces help guide the user through building. Texture change along floor edges help warn the visually impaired user. Large glazed surfaces emit natural light as well as allow the user orientate themselves easily.



Courtyard spaces between buildings could become spaces that the user could relax or socialise with other users.

54



Sketch perspective showing covered walkway. The use of colour and texture create a stimulating environment.

DESIGN PROCESS

Design development

At this point in the design process - interviews and research into space making and program continued. The initial design layout began to pose 3 major problems.

- 1) Buildings were strung along the site resulting in a fragmented proposal
- 2) The focal point needed to be strengthened
- 3) A stronger connection of the site to the urban surroundings needed to be resolved.

"A square that breaths" by Aldo van Eyck began to inspire me. The square allows for opportunity between the fragments. The arrangement of the spaces around fragments are organised and relate to a central space- *the focal point*. Saynatsalo town hall - discussed in the precedent study- at some level relates to 'the square that breaths'. Aalto also separates building at two points creating the opportunity for one to pass through the courtyard to get to the other side.

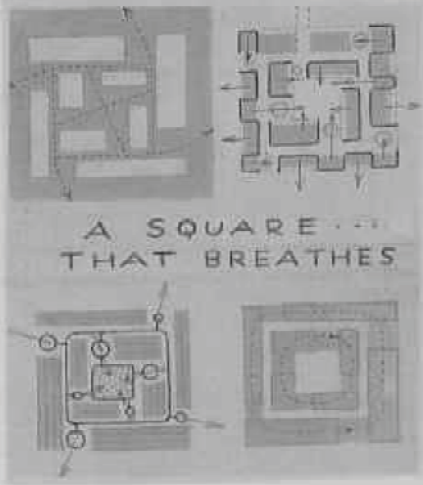

Applying this basic concept to the design as well addressing the urban connection issue resulted in the following design sketches.

Aldo van Eyck, a square that breaths. (Liggett 1990:115)

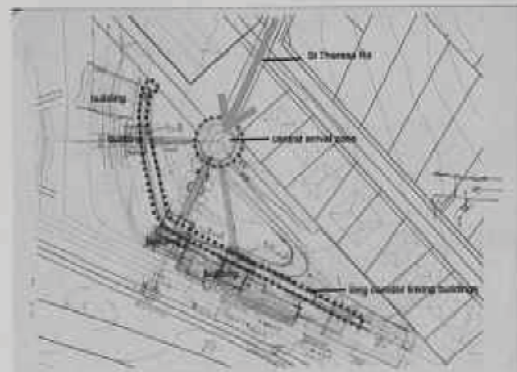

Pulling existing St Theresa Rd and terminating it with a public public space

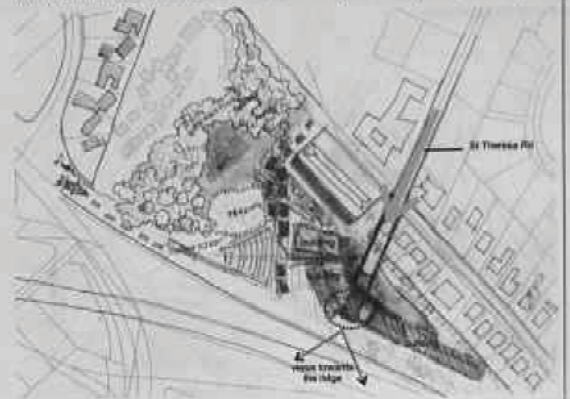

Extending the road and terminated it with a view of the Ridge. Building still wrap around the edges of the contours forming an arc. Walkway from one building to the other still is long. Need increase density.

DESIGN PROCESS

Design development



This sketch focuses on the focal point and axes. The pedestrian route takes the traveler between the buildings into a central space. The central space is on access to the road and the pathway

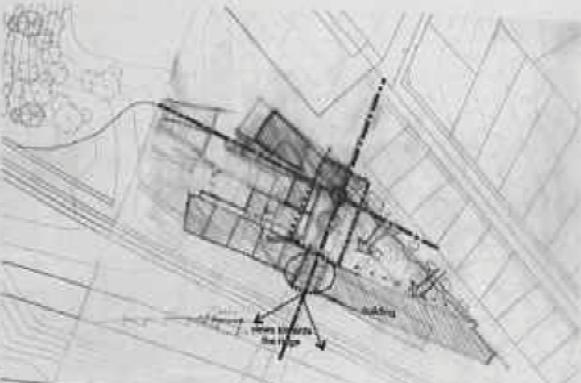

This sketch focuses on the further development of the focal point and axes.

56

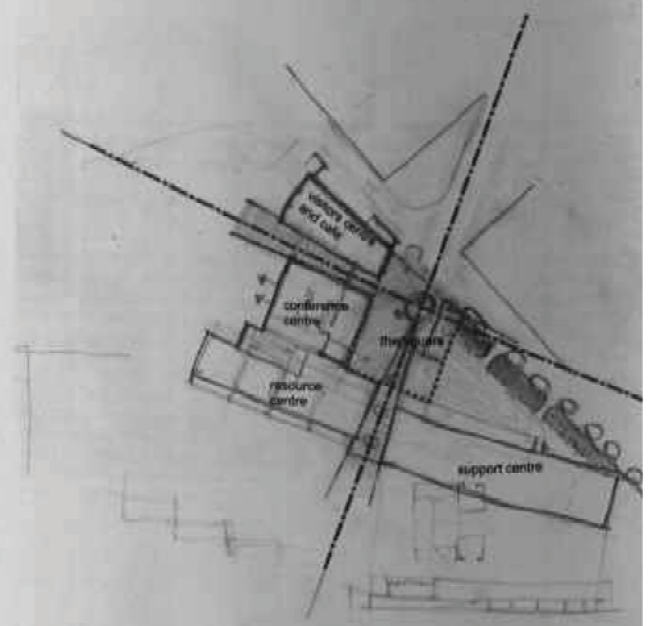

This sketch focuses on the further development of the focal point and axes and defining the favourable positions of building.

Final Design

Site Plan

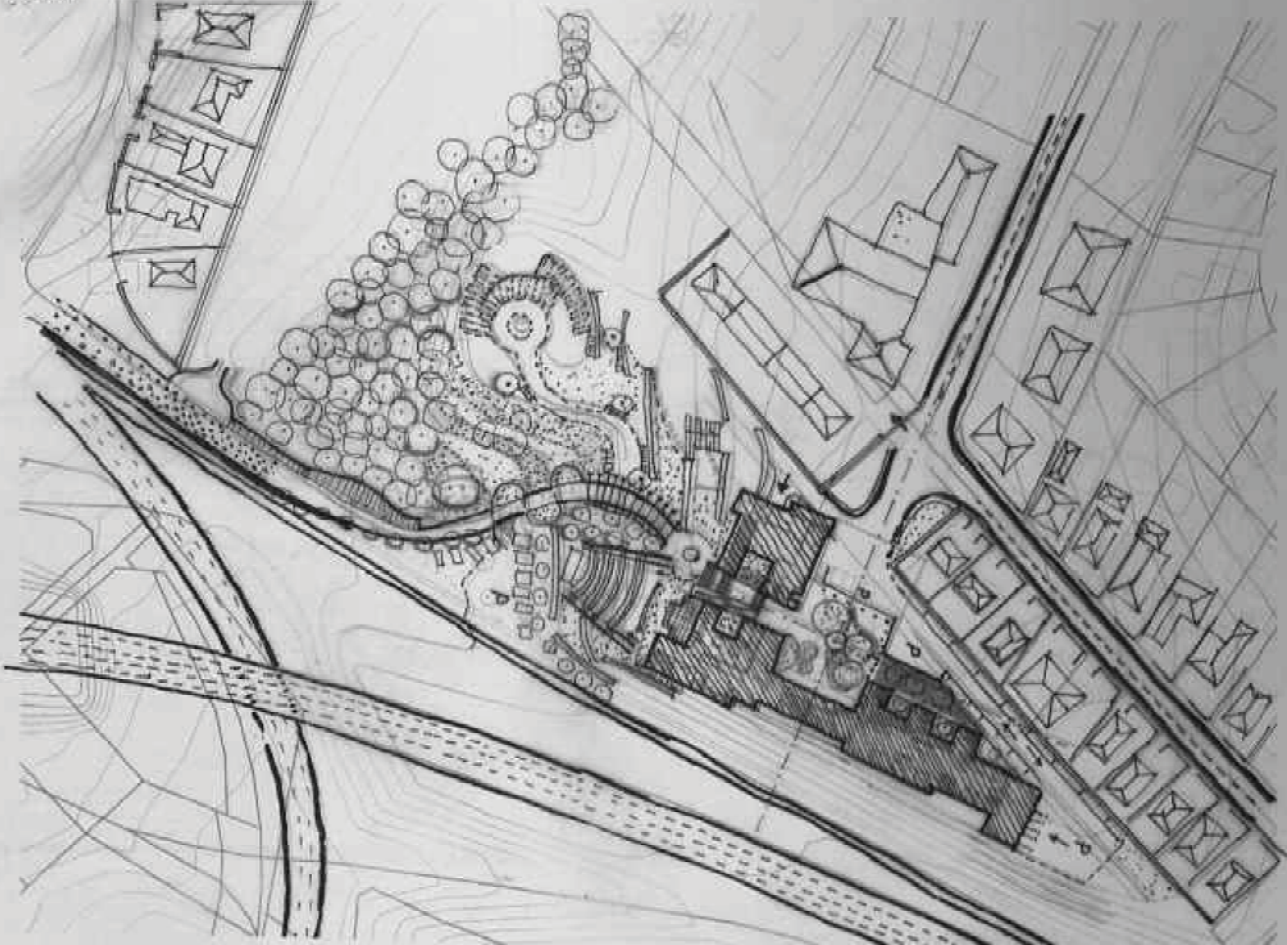

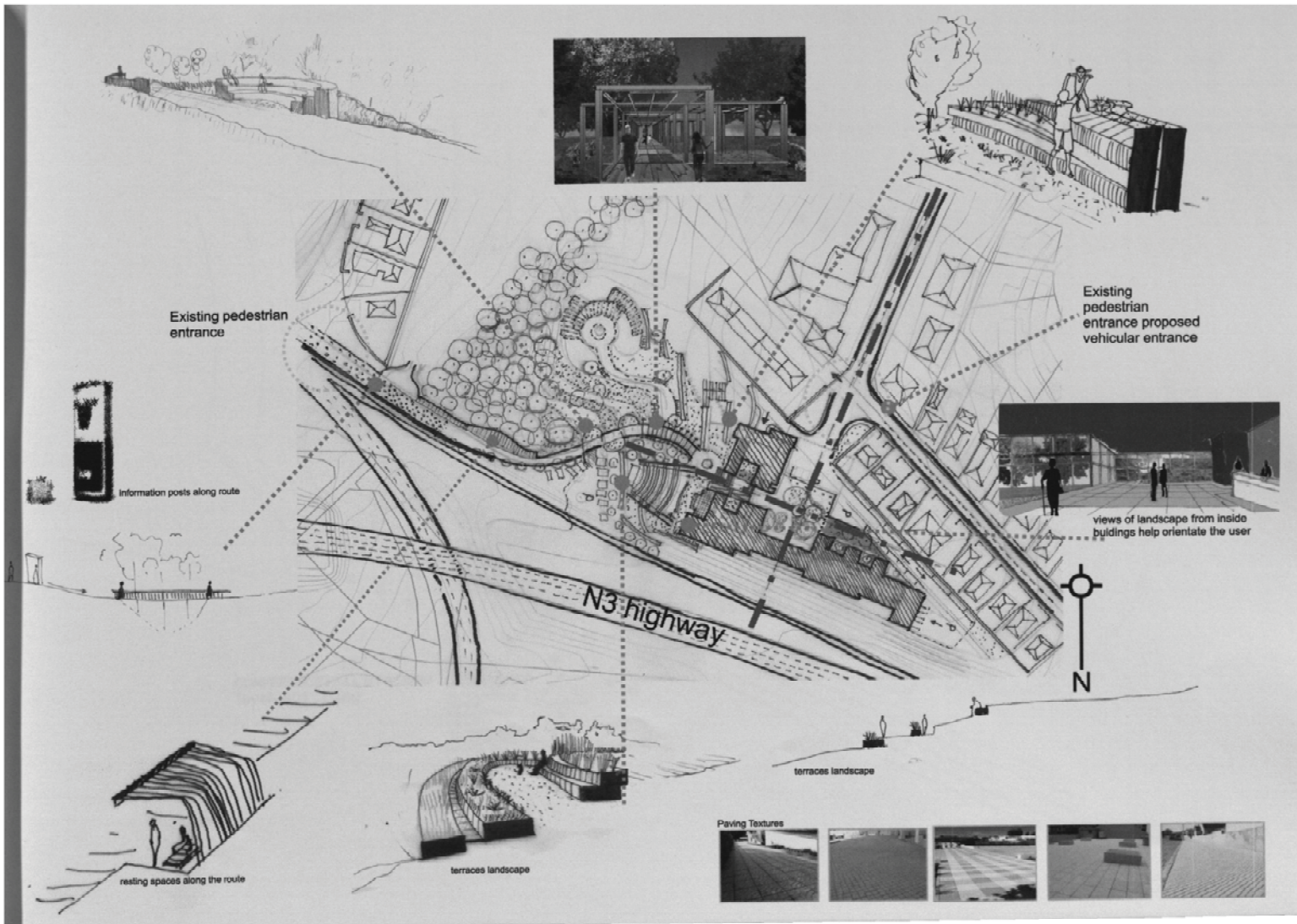

**CONFERENCE HALL & PARKING
level- 001 : [-3m]**

- legend
001-parking
002-paving leading to lift
003-storage room
004-equipment room
005-foyer
006-conference hall
007-balcony
008-meeting room 1
009-meeting room 2
010-female toilet
011-male toilet
012-Disable toilet

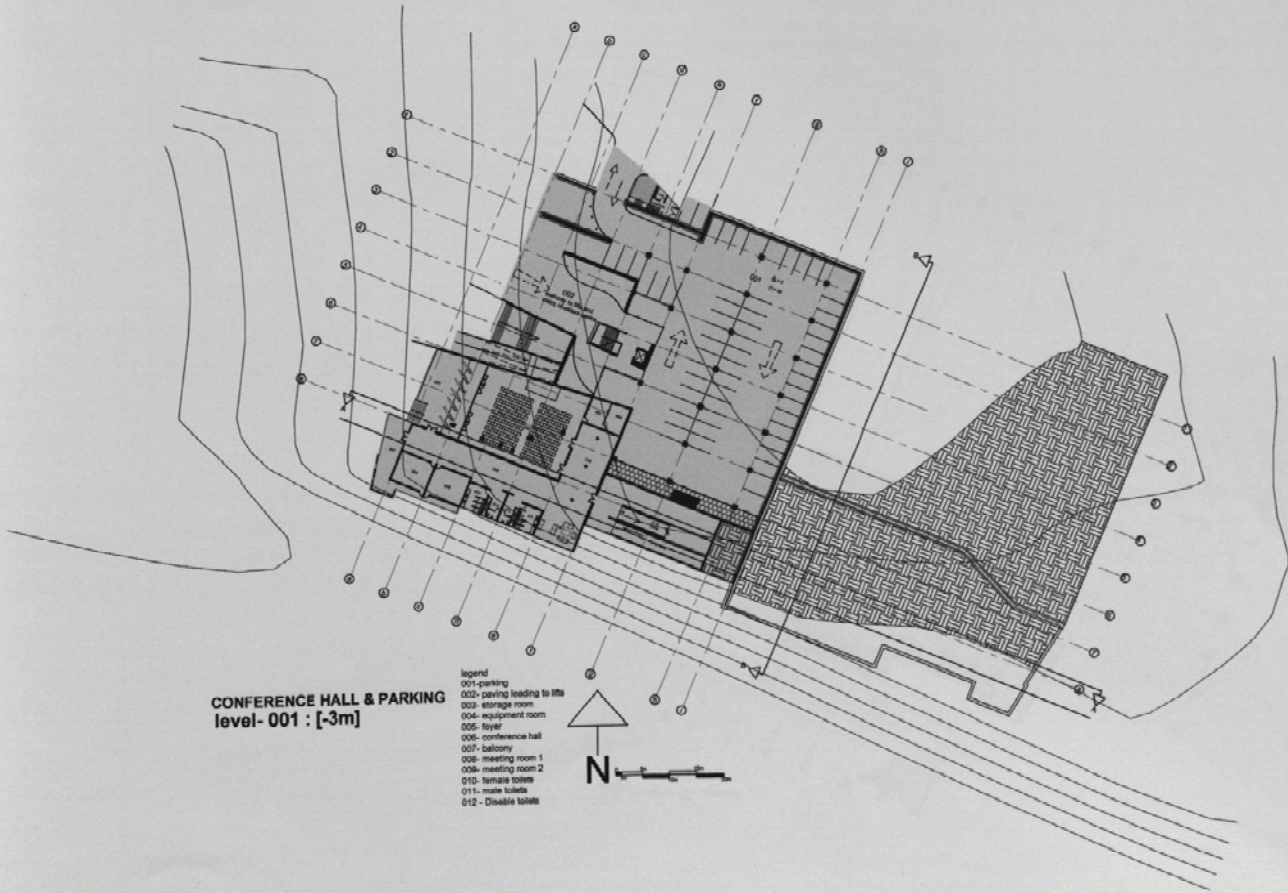
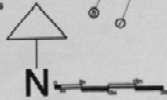

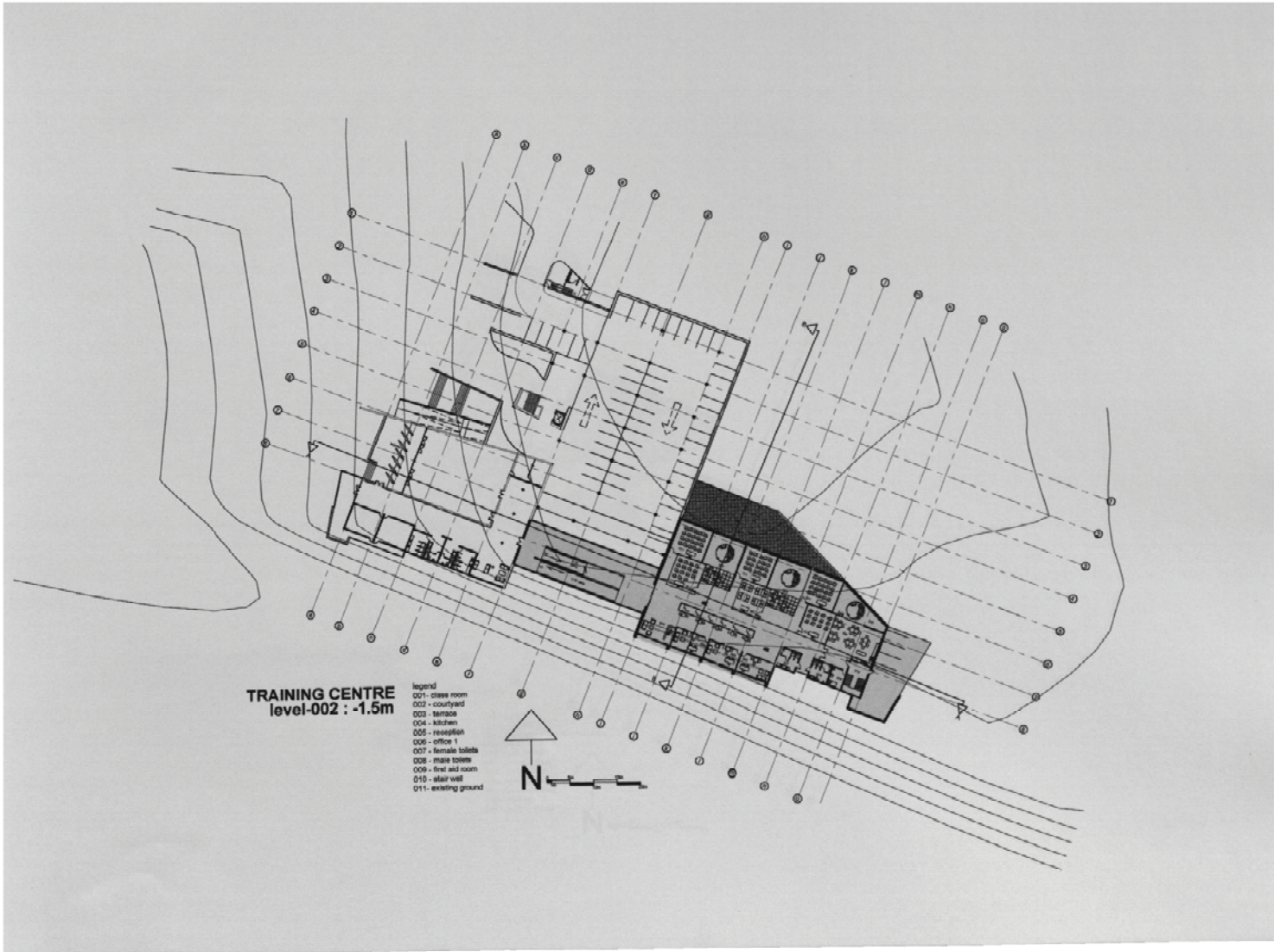

VISTORS AND RESOURCE CENTRE
level-003 : [0]

- Legend
- | | |
|---|--------------------------------------|
| Visitors centre | |
| 001 - Arts and craft shop (some made by disabled individuals) | 007 - gallery |
| 002 - info desk | Resource centre |
| 003 - cafe | 008 - resource centre reception desk |
| 004 - kitchen | 009 - foyer |
| 005 - male toilets | 010 - male toilets |
| 006 - female toilets | 011 - disable toilets |
| | 012 - female toilets |
| | 013 - reading room |
| | 014 - computer room |
| | 015 - balcony |
| | 016 - ramp to library |

